

A.O. SMITH

WATER PRODUCTS COMPANY

PSD-1-293

GAS

RESIDENTIAL WATER HEATER PARTS LIST
MODELS FSG-30, 40, 50
FSGH-30, 40, 50
FSG L-30, 40
SERIES: 248/249

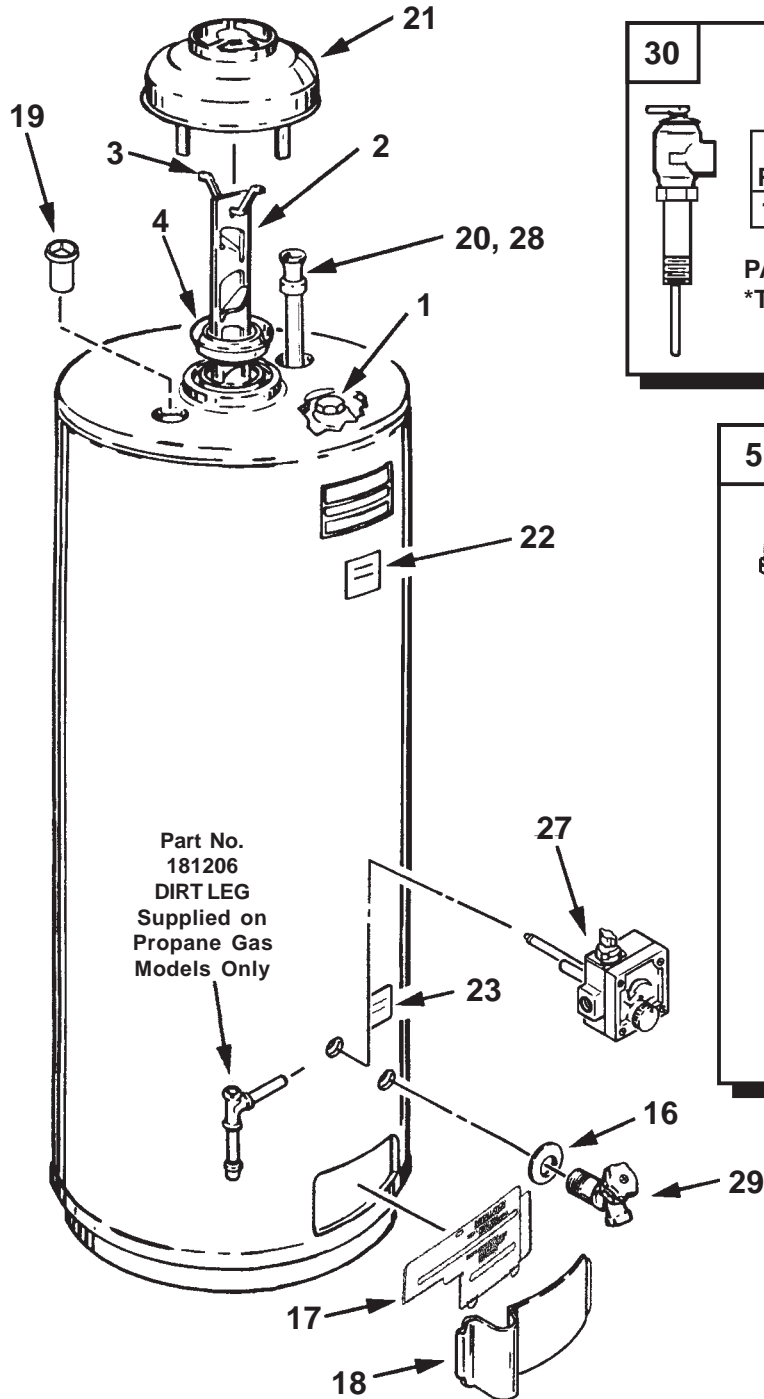

30

RELIEF VALVE

AUTOMATIC (SELF CLOSING) TYPE

PRESS.	*TYPE	SIZE	TEMP RELIEF
150lbs.	T & P	3/4" X 3/4"	210°

PART NO. 43151-2
*Temperature & Pressure

5

BURNER ASSEMBLY

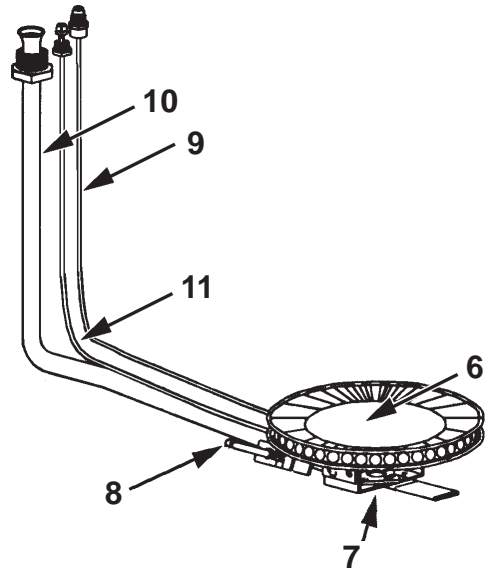

A.O. SMITH WATER PRODUCTS CO., INC.

5621 W. 115TH STREET • ALSIP, ILLINOIS 60803

PHONE: 1-800-433-2545 • FAX: 1-800-433-2515

Website: www.hotwater.com/parts • EMAIL: parts@hotwater.com

Item	Description	FSG	FSG	FSG
		30	40	50
		248/249	248/249	248/249
1	Anode	183523-23	183523-26	183523-29
	BAFFLE			
2	Baffle, Flue	181811	181811	181589
3	Baffle, Hanger	181360	181360	181360
4	Restrictor, Flue	-----	34894	34894
5	BURNER ASS'Y, MAIN-NAT			
	Series 248 Only	182725-12	182725-8	182725-4
5	BURNER ASS'Y, MAIN-PROP.			
	Series 249 Only	182725-13	182725-9	182725-5
6	Burner, Main	182730	182730	182730
7	Orifice, Main-Nat. (Series 248 only)	181508-37	181508-36	181508-31
7	Orifice, Main-Prop. (Series 249 only)	181791-52	181791-52	181791-50
8	BURNER ASS'Y, PILOT-NAT.			
	Series 248 Only	182729-7	182729-4	182729-4
8	BURNER ASS'Y, PILOT-PROP.			
	Series 249 Only	182729-9	182729-5	182729-5
9	Thermocouple	23673	23675	23675
10	TUBE, MAIN BURNER-NAT.			
	Series 248 Only	182727	182727-1	182727-3
10	TUBE, MAIN BURNER-PROP.			
	Series 249 Only	182728	182728-1	182728-3
11	Tube, Pilot	23330	23330	23330
	*CLEANOUT ASS'Y-FSG40C Only			
12	*Cover, Panel Cleanout	-----	181260-700	-----
13	*Cover, Cleanout	-----	99037	-----
14	*Gasket	-----	99038	-----
15	*Screw	-----	69852-1	-----
16	Collar, Pipe	20172-17	20172-17	20172-17
	DOOR			
17	Inner	183491	183491	183491
18	Outer	180522	180522	180522
19	Heat Trap-Outlet, "T" Models Only	181235	181235	181235
20	Heat Trap-Inlet Tube, "T" Models Only	181068-33	181068-33	181068-35
21	Hood, Draft	181082	181082	181082
	LABEL			
22	Flammable Vapor/Scald Instr. Label	183300	183300	183300
23	Lighting & Operating Label	182798	182798	182798
25	*Manual, Instruction	183522	183522	183522
	THERMOSTAT			
27	Nat. (Series 248 only)	<u>182791</u>	<u>182791</u>	<u>182791</u>
27	Prop. (Series 249 only)	<u>182792</u>	<u>182792</u>	<u>182792</u>
28	Tube, Inlet	160907-35	160907-33	160907-35
29	Valve, Drain	42037	42037	42037
30	Valve, T & P	76527-3	76527-3	76527-3

"T" Identifies Heat Trap Models. NOTE: Underlined parts are recommended stock items for emergency replacement. Considered gas used in your area only. *Not illustrated.

FSGH 30 248/249	FSGH 40 248/249	FSGH 50 248/249	FSGL 30 248/249	FSGL 40 248/249
183523-23.....	183523-26	183523-29	183523-23	183523-26
181589	181589	181589	181589-1	181589-1
181360	181360	181360	181360	181360
34894	34894	34894	34894	34894
182725-6.....	182725-15	182725-4	182725-17	182725-31
182725-1.....	182725-16	182725-5	182725-28	182725-32
182730	182730	182730	182730	182730
181508-31.....	181508-31	181508-31	181508-32	181508-31
181791-50.....	181791-50	181791-50	181791-50	181791-50
182729-7.....	182729-4	182729-4	182729-4	182729-4
182729-9.....	182729-5	182729-5	182729-5	182729-3
23673	23675	23675	23675	23675
182727	182727-1	182727-3	182727-1	182727-3
182728	182728	182728	182728-1	182728-1
23330	23330	23330	23330	23330
.....
.....
.....
.....
20172-17.....	20172-17	20172-17	20172-17	20172-17
183491	183491	183491	183491	183491
180522	180522	180522	180522	180522
181235	181235	181235	181235	181235
181068-35.....	281068-35	181068-35	181068-26	181068-26
181082	181082	181082	181082	181082
183300	183300	183300	183300	183300
182798	182798	182798	182798	182798
183522	183522	183522	183522	183522
<u>182791</u>	<u>182791</u>	<u>182791</u>	<u>182791</u>	<u>182791</u>
<u>182792</u>	<u>182792</u>	<u>182792</u>	<u>182792</u>	<u>182792</u>
160907-35.....	160907-35	160907-35	160907-26	160907-26
42037	42037	42037	42037	42037-1
76527-3.....	76527-3	76527-3	76527-3	76527-3

Item	Description	FSG	FSG	FSG
		30	40	50
		248/249	248/249	248/249
SMR S44				
1	Anode	183463-23	183463-23	183463-29
20	Heat Trap-Inlet Tube, "T" Models Only	181068-33	181068-33	181068-35
28	Tube, Inlet.....	160907-35	160907-33	160907-35
SMR H43				
20	Heat Trap-Inlet Tube, "T" Models Only	181068-33	181068-33	181068-35
28	Tube, Inlet.....	160907-35	160907-33	160907-35
30	Valve, T & P	76527-3	76527-3	76527-3
SMR S19				
1	Anode	183463-23	183463-23	183463-29
SMR P83				
29	Valve, Drain	26273-5	26273-5	26273-5
30	Valve, T & P	76527-3	76527-3	76527-3
SMR S06				
	*Manual, Instruction	181809	181809	181809
SMR K32-249 SERIES				
1	Anode	183463-23	183463-23	183463-29
5	BURNER ASS'Y, MAIN-PROP.	182725-34	182725-11	182725-7
7	Orifice, Main-Prop.	181791-53	181791-53	181791-51
8	Burner Ass'y, Pilot-Prop.	182729-9	182729-5	182729-5
SMR K32-248 SERIES				
1	Anode	183463-23	183463-23	183463-29
5	BURNER ASS'Y, MAIN-NAT.	182725-14	182725-10	182725-6
7	Orifice, Main-Nat.	181508-39	181508-38	181508-32
8	Burner Ass'y, Pilot-Nat.	182729-8	182729-6	182729-6
SMR S34				
1	Anode	183463-23	183463-23	183463-29
30	Valve, T & P	76527-3	76527-3	76527-3
SMR S45				
1	Anode	183463-23	183463-23	183463-29
	*Nipple	38469-4	38469-4	38469-4
SMR R99				
5	BURNER ASS'Y, MAIN-NAT	-----	-----	183511-3
7	Orifice, Main-Nat.	-----	-----	181508-31
8	Burner Ass'y, Pilot-Nat.	-----	-----	182729-4
25	*Manual, Instruction	-----	-----	181809
SMR S49				
1	Anode	-----	-----	181125-42
5	BURNER ASS'Y, MAIN-NAT	-----	-----	183511-3
7	Orifice, Main-Nat.	-----	-----	181508-31
8	Burner Ass'y, Pilot-Nat.	-----	-----	182729-4
25	*Manual, Instruction	-----	-----	181809
	*Nipple	-----	-----	38469-4
SMR S50				
1	Anode	181125-42	181125-42	-----
5	BURNER ASS'Y, MAIN-NAT.	182725-14	182725-10	-----
7	Orifice, Main-Nat.	181508-39	181508-38	-----
8	Burner Ass'y, Pilot-Nat.	182729-8	182729-6	-----
	*Nipple	38469-4	38469-4	-----
SMR S69				
29	Valve, Drain	26273-5	26273-5	26273-5
SMR S22				
25	*Manual, Instruction	180856	180856	180856
	*Tube, Runoff	24120	24120	24120
30	Valve, T & P	76527-3	76527-3	43151-2
SMR S29				
1	Anode	183463-23	183463-23	183463-29
	*Nipple	38469-10	38469-10	38469-10

"T" Identifies Heat Trap Models. NOTE: Underlined parts are recommended stock items for emergency replacement. Considered gas used in your area only. *Not illustrated.

FSGH 30 248/249	FSGH 40 248/249	FSGH 50 248/249	FSGH 30 248/249	FSGH 40 248/249
183463-23	183463-26	183463-29	183463-19	183463-23
181068-35	181068-35	181068-35	181068-26	181068-26
160907-35	160907-35	160907-35	160907-26	160907-26
181068-35	181068-35	181068-35	181068-26	181068-26
160907-35	160907-35	160907-35	160907-26	160907-26
76527-3	76527-3	76527-3	76527-3	76527-3
183463-23	183463-26	183463-29	183463-19	183463-23
-----	-----	-----	26273-5	26273-5
-----	-----	-----	76527-3	76527-3
181809	181809	181809	181809	181809
183463-23	183463-26	183463-29	183463-19	183463-23
182725-3	182725-18	182725-7	182725-30	182725-33
181791-51	181791-51	181791-51	181791-53	181791-51
182729-9	182729-5	182729-5	182729-9	182729-3
183463-23	183463-26	183463-29	183463-19	183463-23
182725-2	182725-41	182725-6	182725-29	182725-21
181508-32	181508-32	181508-32	181508-32	181508-32
182729-8	182729-6	182729-6	182729-8	182729-6
183463-23	183463-26	183463-29	183463-19	183463-23
76527-3	76527-3	76527-3	76527-3	76527-3
183463-23	183463-26	183463-29	183463-19	183463-23
38469-4	38469-4	38469-4	38469-4	38469-4
183511	183511-1	183511-3	-----	-----
181508-31	181508-31	181508-31	-----	-----
182729-7	182729-4	182729-4	-----	-----
181809	181809	181809	-----	-----
181125-42	181125-42	181125-42	-----	-----
183511	183511-1	183511-3	-----	-----
181508-31	181508-31	181508-31	-----	-----
182729-7	182729-4	182729-4	-----	-----
181809	181809	181809	-----	-----
38469-4	38469-4	38469-4	-----	-----
181125-42	181125-42	181125-42	-----	-----
182725-2	182725-41	182725-6	-----	-----
181508-32	181508-32	181508-32	-----	-----
182729-8	182729-6	182729-6	-----	-----
38469-4	38469-4	38469-4	-----	-----
26273-5	26273-5	26273-5	26273-5	26273-5
-----	-----	-----	-----	-----
-----	-----	-----	-----	-----
-----	-----	-----	183463-19	183463-23
-----	-----	-----	38469-10	38469-10

A.O. SMITH
WATER PRODUCTS
COMPANY



A.O. SMITH WATER PRODUCTS CO., INC.
5621 W. 115TH STREET • ALSIP, ILLINOIS 60803
PHONE: 1-800-433-2545 • FAX: 1-800-433-2515
Website: www.hotwater.com/parts • EMAIL: parts@hotwater.com