

A.O. SMITH

WATER PRODUCTS COMPANY

PSD-1-204

GAS

RESIDENTIAL WATER HEATER PARTS LIST
 MODELS PGX-30, 40, 50
 PGXH-30, 40, 50
 PGXL-30, 40
 SERIES: 248/248E/249

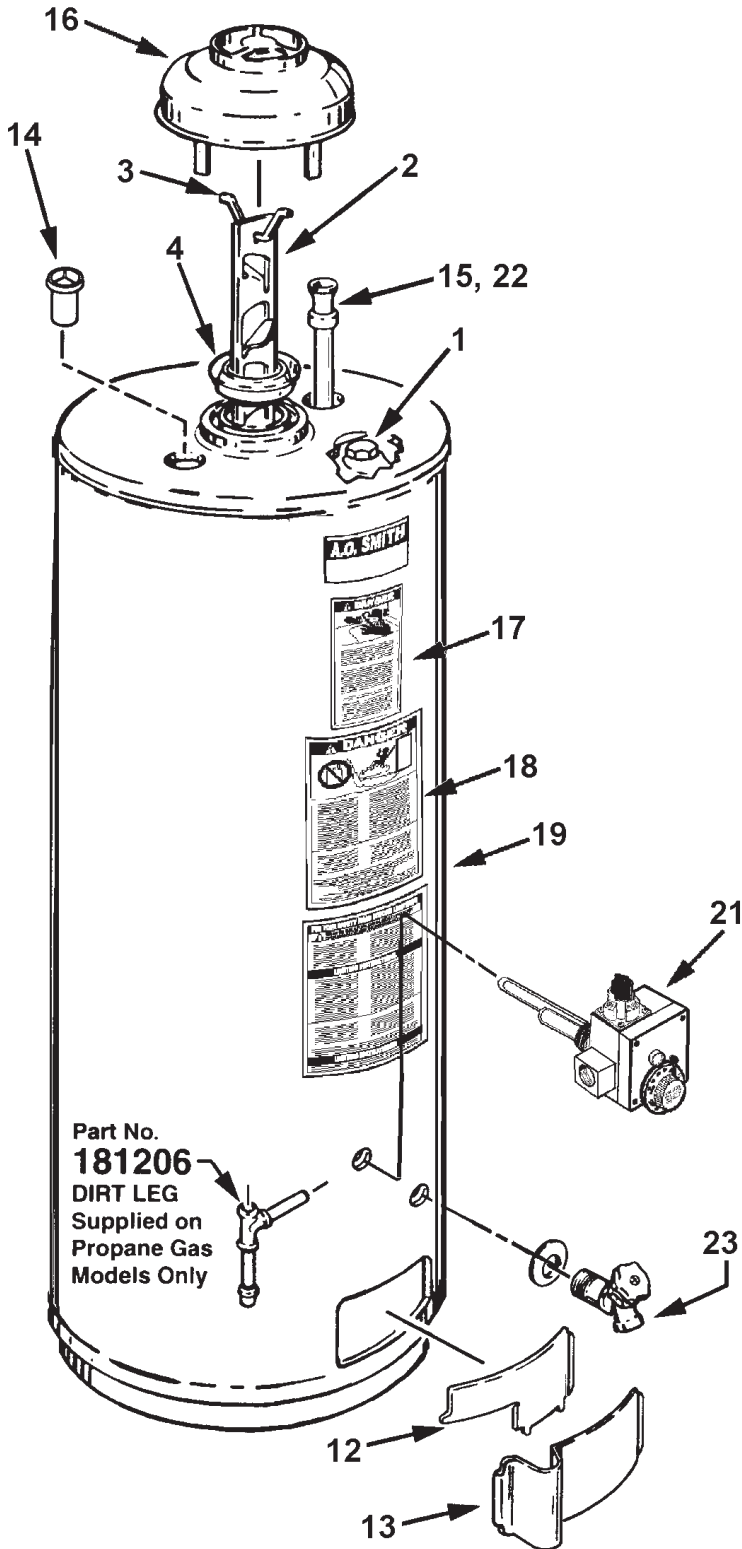

24 T&P RELIEF VALVE

| PRESS. | *TYPE | SIZE | TEMP. RELIEF |
|----------|-------|-------------|--------------|
| 150 lbs. | T & P | 3/4" X 3/4" | 210° |

Part No. 76527-3

BURNER ASSEMBLY ALL OTHER MODELS

5

A.O. SMITH WATER PRODUCTS COMPANY
 5621 W. 115th Street, Alsip, Illinois 60803
 PHONE: 1-800-433-2545 • FAX: 1-800-433-2515
 Website: www.aosmithwaterheaters.com • E-mail: parts@hotwater.com

| Item | Description | PGX(T) | PGX(T) | PGX(T) |
|------|---|-----------------|-----------------|-----------------|
| | | 30 | 40 | 50 |
| | | 248/249 | 248/249 | 248/248E/249 |
| 1 | Anode | 183463-29 | 183463-35 | 183463-42 |
| | BAFFLE | | | |
| 2 | Baffle, Flue | 181811 | 181811 | 181589 |
| 3 | Hanger, Baffle | 181360 | 181360 | 181360 |
| 4 | Restrictor, Flue | - - - | 34894 | 34894 |
| 5 | BURNER ASS'Y, MAIN - Natural | | | |
| | Series 248 Only | 182725-12 | 182725-8 | 182725-4 |
| 5 | BURNER ASS'Y, MAIN - Propane | | | |
| | Series 249 Only | 182725-13 | 182725-9 | 182725-5 |
| 5 | BURNER ASS'Y, MAIN | | | |
| | Series 248E Only | - - - | - - - | 183511-3 |
| 6 | Burner, Main - Series 248E Only | - - - | - - - | 183504 |
| 6 | Burner, Main - Natural | 182730 | 182730 | 182730 |
| 6 | Burner, Main - Propane | 182730 | 182730 | 182730 |
| 7 | Orifice, Main - Series 248E Only | - - - | - - - | 181508-31 |
| 7 | Orifice, Main - Natural | 181508-37 | 181508-36 | 181508-31 |
| 7 | Orifice, Main - Propane | 181791-52 | 181791-52 | 181791-50 |
| 8 | Burner Ass'y, Pilot - Natural | | | |
| | Series 248 Only | <u>182729-7</u> | <u>182729-4</u> | <u>182729-4</u> |
| 8 | Burner Ass'y, Pilot - Propane | | | |
| | Series 249 Only | <u>182729-9</u> | <u>182729-5</u> | <u>182729-5</u> |
| 9 | Thermocouple | <u>23673</u> | <u>23673</u> | <u>23673</u> |
| 10 | Tube, Main Burner - Natural | | | |
| | Series 248 & 248E Only | 182727-0 | 182727-1 | 182727-3 |
| 10 | Tube, Main Burner - Propane | | | |
| | Series 249 Only | 182728-0 | 182728-1 | 182728-3 |
| 11 | Tube, Pilot | 23925-20 | 23925-20 | 23925-20 |
| | DOOR | | | |
| 12 | Inner | 183491 | 183491 | 183491 |
| 13 | Outer | 180522 | 180522 | 180522 |
| 14 | Heat Trap - Outlet, "T" Models Only | 181235 | 181235 | 181235 |
| 15 | Heat Trap - Inlet Tube, "T" Models Only | 181068-33 | 181068-33 | 181068-35 |
| 16 | Hood Draft | 181082 | 181082 | 181082 |
| | LABEL | | | |
| 17 | Flammable Vapor/Scald | 183300 | 183300 | 183300 |
| 18 | Scald Warning | 181138 | 181138 | 181138 |
| 19 | Lighting & Operating | 182798 | 182798 | 182798 |
| 20 | *Manual, Instruction | 183522 | 183522 | 183522 |
| | THERMOSTAT | | | |
| 21 | Natural | <u>182791</u> | <u>182791</u> | <u>182791</u> |
| 21 | Propane | <u>182792</u> | <u>182792</u> | <u>182792</u> |
| 22 | Tube, Inlet | 160907-35 | 160907-33 | 160907-35 |
| 23 | Valve, Drain | 42037 | 42037 | 42037 |
| 24 | Valve, T & P | 76527-3 | 76527-3 | 76527-3 |
| | SMR S44 | | | |
| 1 | Anode | 183463-29 | 183463-35 | 183463-29 |
| 15 | Heat Trap - Inlet Tube, "T" Models Only | 183359-33 | 183359-33 | 183359-35 |
| 22 | Tube, Inlet | 183352-35 | 183352-33 | 183352-35 |
| | SMR H43 | | | |
| 15 | Heat Trap - Inlet Tube, "T" Models Only | 183354-33 | 183354-33 | 183354-35 |
| 22 | Tube, Inlet | 183352-35 | 183352-33 | 183352-35 |
| 24 | Valve, T & P | 76527-3 | 76527-3 | 76527-3 |
| | SMR S19 | | | |
| 1 | Anode | 183463-29 | 183463-35 | 183463-29 |
| | SMR S06 | | | |
| 20 | *Manual, Instruction | 181809 | 181809 | 181809 |
| | SMR K32 - 249 Series | | | |
| 1 | Anode | 183463-29 | 183463-35 | 183463-29 |
| 5 | BURNER ASS'Y, Main - Propane | 182725-34 | 182725-11 | 182725-7 |
| 8 | Burner Ass'y, Pilot - Propane | 182729-9 | 182729-5 | 182729-5 |
| 7 | Orifice, Main - Propane | 181791-53 | 181791-53 | 181791-51 |
| | SMR K32 - 248 Series | | | |
| 1 | Anode | 183463-29 | 183463-35 | 183463-29 |
| 5 | BURNER ASS'Y, Main - Natural | 182725-14 | 182725-10 | 182725-6 |
| 8 | Burner Ass'y Pilot - Natural | 182729-8 | 182729-6 | 182729-6 |
| 7 | Orifice, Main - Natural | 181508-39 | 181508-38 | 181508-32 |

"T" Identifies Heat Trap Models.

NOTE: Underlined parts are recommended stock items for emergency replacement.

Consider gas used in your area only.

*Not illustrated.

| PGXH(T) 30 248/248E/249 | PGXH(T) 40 248/248E/249 | PGXH(T) 50 248/248E/249 | PGXL(T) 30 248/248E | PGXL(T) 40 248/248E/249 |
|-------------------------------|-------------------------------|-------------------------------|---------------------------|-------------------------------|
| 183463-32 | 183463-35 | 183463-42 | 183463-42 | 183463-42 |
| 181589 | 181589 | 181589 | 181589-1 | 181589-1 |
| 181360 | 181360 | 181360 | 181360 | 181360 |
| 34894 | 34894 | 34894 | 34894 | 34894 |
| 182725-0 | 182725-15 | 182725-4 | 182725-17 | 182725-21 |
| 182725-1 | 182725-16 | 182725-5 | - - - | 182725-32 |
| 183511 | 183511-1 | 183511-3 | 183511-1 | 183511-3 |
| 183504 | 183504 | 183504 | 183504 | 183504 |
| 182730 | 182730 | 182730 | 182730 | 182730 |
| 182730 | 182730 | 182730 | 182730 | 182730 |
| 181508-32 | 181508-31 | 181508-31 | 181508-31 | 181508-31 |
| 181508-31 | 181508-31 | 181508-31 | 181508-32 | 181508-31 |
| 181791-50 | 181791-50 | 181791-50 | - - - | 181791-50 |
| <u>182729-7</u> | <u>182729-4</u> | <u>182729-4</u> | <u>182729-4</u> | <u>182729-6</u> |
| <u>182729-9</u> | <u>182729-5</u> | <u>182729-5</u> | - - - | <u>182729-5</u> |
| <u>23673</u> | <u>23673</u> | <u>23673</u> | <u>23673</u> | <u>23673</u> |
| 182727-0 | 182727-1 | 182727-3 | 182727-1 | 182727-3 |
| 182728-0 | 182728-1 | 182728-3 | - - - | 182728-3 |
| 23925-20 | 23925-20 | 23925-20 | 23925-20 | 23925-20 |
| 183491 | 183491 | 183491 | 183491 | 183491 |
| 180522 | 180522 | 180522 | 180522 | 180522 |
| 181235 | 181235 | 181235 | 181235 | 181235 |
| 181068-35 | 181068-35 | 181068-35 | 181068-26 | 181068-26 |
| 181082 | 181082 | 181082 | 181082 | 181082 |
| 183300 | 183300 | 183300 | 183300 | 183300 |
| 181138 | 181138 | 181138 | 181138 | 181138 |
| 182798 | 182798 | 182798 | 182798 | 182798 |
| 183522 | 183522 | 183522 | 183522 | 183522 |
| <u>182791</u> | <u>182791</u> | <u>182791</u> | <u>182791</u> | <u>182791</u> |
| <u>182792</u> | <u>182792</u> | <u>182792</u> | - - - | <u>182792</u> |
| 160907-35 | 160907-35 | 160907-35 | 160907-26 | 160907-26 |
| 42037 | 42037 | 42037 | 42037 | 42037 |
| 76527-3 | 76527-3 | 76527-3 | 76527-3 | 76527-3 |
| 183463-32 | 183463-35 | 183463-42 | 183463-42 | 183463-42 |
| 183354-35 | 183354-35 | 183354-35 | 183354-26 | 183354-26 |
| 183352-35 | 183352-35 | 183352-35 | 183352-26 | 183352-26 |
| 183354-33 | 183354-33 | 183354-33 | 183354-26 | 183354-26 |
| 183352-35 | 183352-35 | 183352-35 | 183352-26 | 183352-26 |
| 76527-3 | 76527-3 | 76527-3 | 76527-3 | 76527-3 |
| 183463-32 | 183463-35 | 183463-42 | 183463-42 | 183463-42 |
| 181809 | 181809 | 181809 | 181809 | 181809 |
| 183463-32 | 183463-35 | 183463-42 | 183463-42 | 183463-42 |
| 182725-3 | 182725-18 | 182725-7 | 182725-30 | 182725-33 |
| 182729-9 | 182729-5 | 182729-5 | 182729-9 | 182729-5 |
| 181791-51 | 181791-51 | 181791-51 | 181791-53 | 181791-51 |
| 183463-32 | 183463-35 | 183463-42 | 183463-42 | 183463-42 |
| 182725-2 | 182725-4 | 182725-6 | 182725-9 | 182725-21 |
| 182729-8 | 182729-6 | 182729-6 | 182729-8 | 182729-6 |
| 181508-32 | 181508-32 | 181508-32 | 181508-32 | 181508-32 |

A.O. SMITH
WATER PRODUCTS
COMPANY

A.O. SMITH WATER PRODUCTS COMPANY

5621 W. 115th Street, Alsip, Illinois 60803

PHONE: 1-800-433-2545 • FAX: 1-800-433-2515

Website: www.aosmithwaterheaters.com • E-mail: parts@hotwater.com