

On-Demand Concentric Vent Components

- For indoor concentric venting models: 305, 505
- These models incorporate a condensate collector and do not require an “adapter” vent component.
- Plastic vent components consist of an outer plastic vent for the air intake and an inner metal vent for the exhaust gases.

Refer to the installation manual and the Ubbink installation instructions for complete installation details and requirements.

We are continually updating and improving products; therefore, specifications are subject to change without prior notice. Local, state, provincial and federal codes must be adhered to prior to installation.

Vertical Venting Material

Roof Discharge Terminal
(Cold Climate)
38" (above roof)
Part No. 9006500005

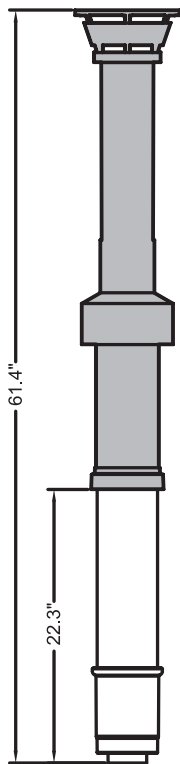

Roof Discharge Terminal
18" (above roof)
38" (above roof)
Part No. 9006499005

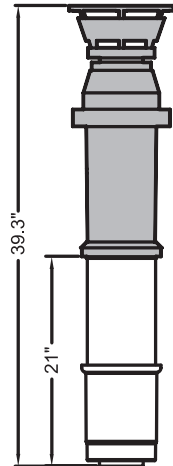

Roof Flashing



Roof Pitch	Part Number
1/12 to 6/12	9006503005
6/12 to 12/12	9006504005
8/12 to 16/12	9006505005

Flat Roof Flashing
Part No. 9006502005

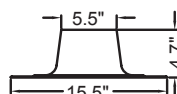

Horizontal Venting Material

Horizontal Termination Kit - 21"
Part No. 9006560005

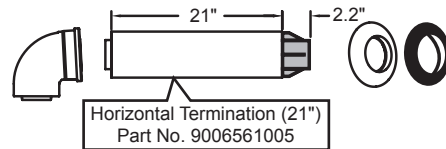

Horizontal Termination (21")
Part No. 9006561005

Horizontal Termination Kit - 12"
Part No. 9006495005

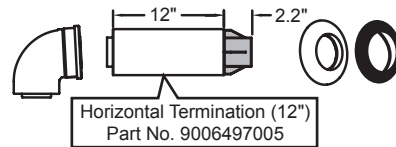

Horizontal Termination (12")
Part No. 9006497005

Bends and Extensions

90° Vent Pipe Elbow
Part No. 9006507005

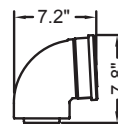

Condensate Collector
Part No. 9006512005

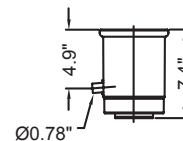

Telescopic Vent Extension
Part No. 9006511005



Eff. Length (2.2 - 12.0 in.)

Vent Pipe Clamp
Part No. 9006513005



* Included with Roof Discharge Terminals

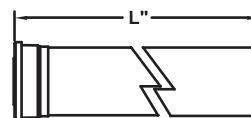

Vent Pipe Extension

Length "L"	Part Number
10"	9006508005
19.5"	9006509005
39"	9006510005

45° Vent Pipe Elbow (Qty. 2)
Part No. 9006506005

